

Shiplap Wall Panel Features:

- Non-Combustible
- Weather resistant
- Custom sized to your exact specifications
- Built-in mounting system

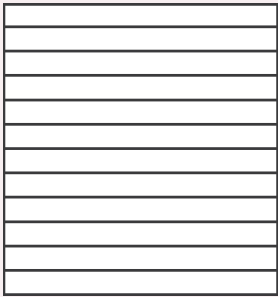

shiplap profile



shiplap wall

Decorative Options*

- | | |
|---------|---|
| Banding | X |
| Rivets | X |

Returns

- | | |
|-----------------|---|
| None | ✓ |
| Forward Facing* | ✓ |
| Rear Facing* | ✓ |

Standard Finishes

- | | |
|-------------------|---|
| Matte Black | ✓ |
| Textured Black | ✓ |
| Bronzed Iron | ✓ |
| Oil Rubbed Bronze | ✓ |
| Charcoal | ✓ |
| Aspire Rust | ✓ |
| Weathered Brown | ✓ |
| Champagne | ✓ |
| Copper Vein | ✓ |
| Nickel Vein | ✓ |
| Vintage Vein | ✓ |
| Silver Vein | ✓ |
| Silver Mist | ✓ |
| White | ✓ |

Premium Finishes*

- | | |
|-------------------|---|
| Antique Black | ✓ |
| Antique Steel | ✓ |
| Antique Red | ✓ |
| Antique Grey | ✓ |
| Antique Bronze | ✓ |
| Antique White | ✓ |
| Burnished Bronze | ✓ |
| Burnished Copper | ✓ |
| Burnished Silver | ✓ |
| Metallic Latte | ✓ |
| Rust Patina | ✓ |
| Hot Roll Natural | X |
| Industrial Black | ✓ |
| Brushed Stainless | X |



Shown in White



Built-in simple mounting system

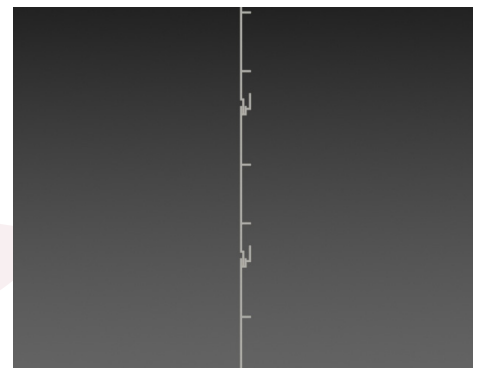

Side Profile

*Additional upcharge may apply